

BODY SECTION

This service manual has been prepared to provide SUBARU service personnel with the necessary information and data for the correct maintenance and repair of SUBARU vehicles.

This manual includes the procedures for maintenance, disassembling, reassembling, inspection and adjustment of components and diagnostics for guidance of experienced mechanics.

Please peruse and utilize this manual fully to ensure complete repair work for satisfying our customers by keeping their vehicle in optimum condition. When replacement of parts during repair work is needed, be sure to use SUBARU genuine parts.

All information, illustration and specifications contained in this manual are based on the latest product information available at the time of publication approval.

| | |
|---|------------|
| HVAC SYSTEM (HEATER, VENTILATOR AND A/C) | AC |
| HVAC SYSTEM (AUTO A/C) (DIAGNOSTIC) | AC |
| AIRBAG SYSTEM | AB |
| AIRBAG SYSTEM (DIAGNOSTIC) | AB |
| SEAT BELT SYSTEM | SB |
| LIGHTING SYSTEM | LI |
| WIPER AND WASHER SYSTEM | WW |
| ENTERTAINMENT | ET |
| COMMUNICATION SYSTEM | COM |
| GLASS/WINDOW/MIRROR | GW |
| BODY STRUCTURE | BS |
| INSTRUMENTATION/DRIVER INFO | IDI |
| SEAT | SE |
| SECURITY AND LOCK | SL |
| SUNROOF/T-TOP/CONVERTIBLE TOP (SUNROOF) | SR |
| EXTERIOR/INTERIOR TRIM | EI |
| EXTERIOR BODY PANEL | EB |

BODY SECTION

CRUISE CONTROL SYSTEM CC

CRUISE CONTROL SYSTEM (DIAGNOSTIC) CC(H4SO)

CRUISE CONTROL SYSTEM (DIAGNOSTIC) CC(H4DOTC)

CRUISE CONTROL SYSTEM (DIAGNOSTIC) CC(H4DOTC 2.5)

IMMOBILIZER (DIAGNOSTIC) IM

SEAT

SE

| | Page |
|------------------------------|-------------|
| 1. General Description | 2 |
| 2. Front Seat | 6 |
| 3. Rear Seat | 13 |

General Description

SEAT

1. General Description

A: COMPONENT

1. FRONT SEAT

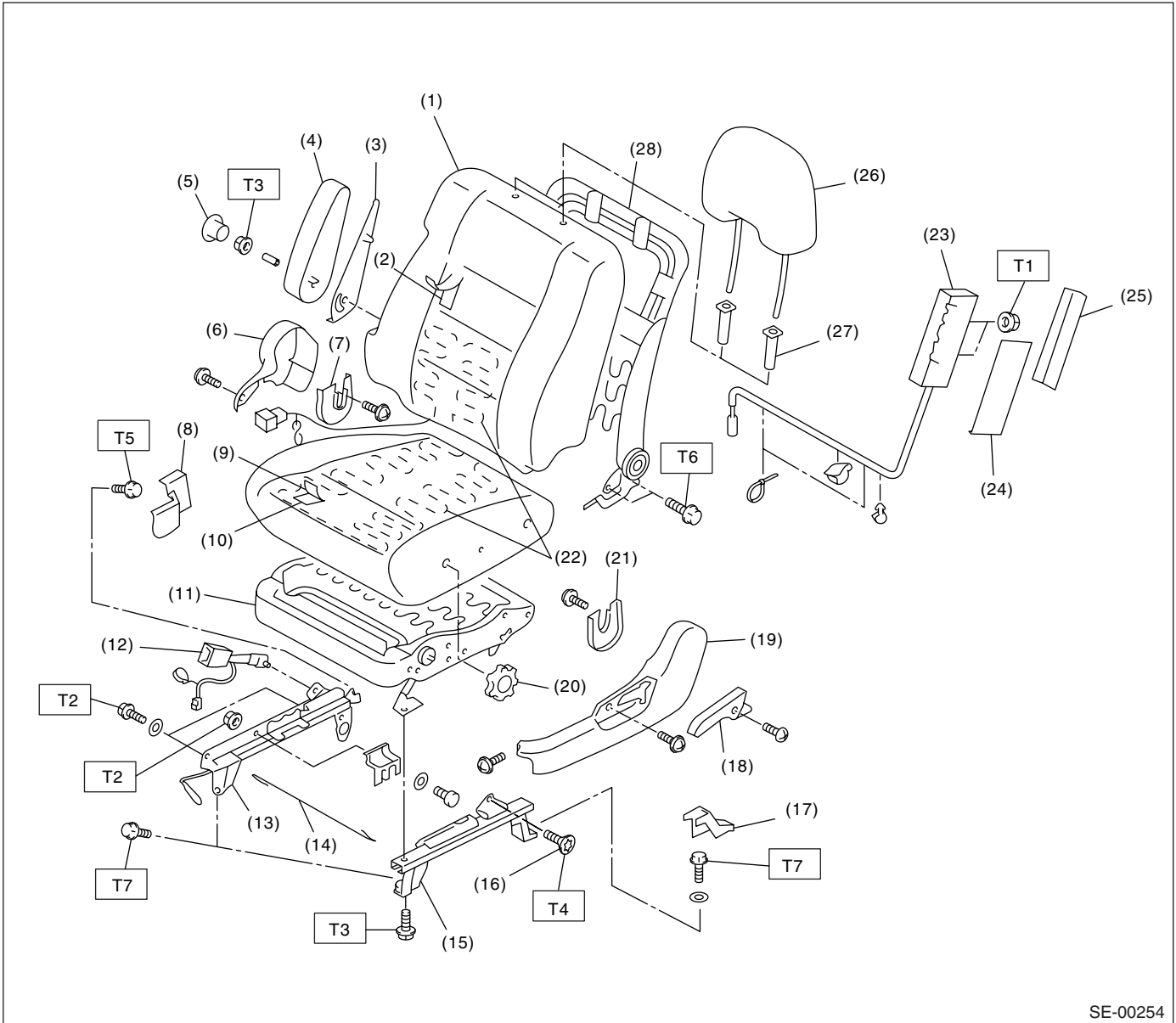

SE-00254

General Description

SEAT

| | | |
|-------------------------------|--------------------------------|----------------------------|
| (1) Backrest cover | (14) Connecting wire | (27) Headrest lock bushing |
| (2) Backrest pad | (15) Outer slide rail | (28) Backrest frame ASSY |
| (3) Backrest side cover | (16) TORX® bolt | |
| (4) Armrest ASSY | (17) Bolt cover RH | |
| (5) Hinge cover cap | (18) Reclining lever | |
| (6) Seat hinge outer cover LH | (19) Seat hinge outer cover RH | |
| (7) Seat hinge inner cover LH | (20) Seat lifter dial | |
| (8) Bolt cover LH | (21) Seat hinge inner cover RH | |
| (9) Seat cushion cover | (22) Seat heater unit | |
| (10) Seat cushion pad ASSY | (23) Side airbag module ASSY | |
| (11) Seat cushion frame ASSY | (24) Support pad (A) | |
| (12) Inner belt | (25) Support pad (B) | |
| (13) Inner slide rail | (26) Headrest ASSY | |

Tightening torque: N·m (kgf-m, ft-lb)

T1: 5.9 (0.6, 4.4)

T2: 10 (1.0, 7.4)

T3: 17.7 (1.8, 13.0)

T4: 20 (2.0, 14.8)

T5: 30 (3.0, 22.1)

T6: 52 (5.3, 38.3)

T7: 53 (5.4, 39.0)

General Description

SEAT

2. REAR SEAT

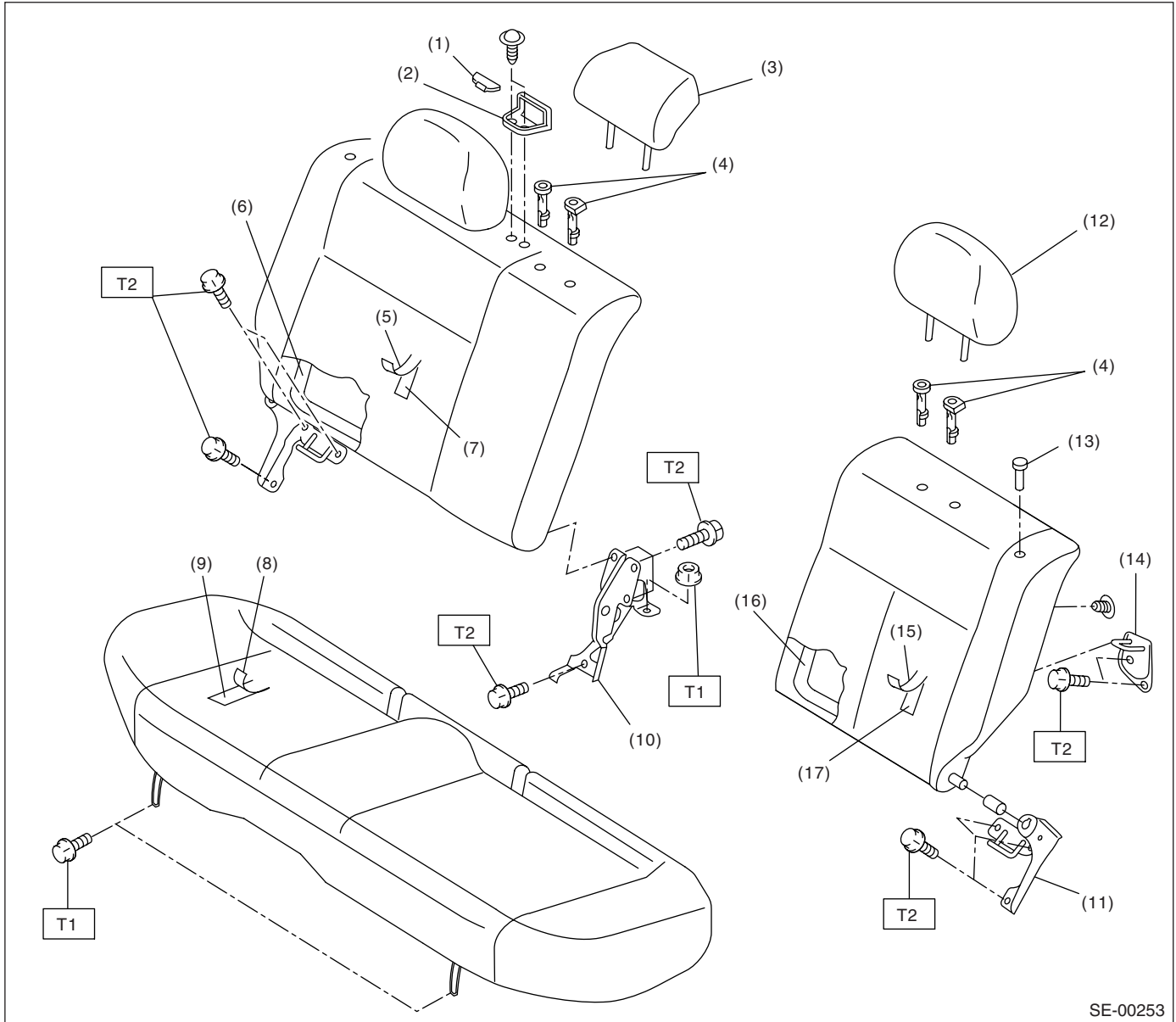

- (1) Webbing guide cap
- (2) Webbing guide
- (3) Center pillow
- (4) Headrest free bushing
- (5) Backrest cover RH
- (6) Backrest frame RH
- (7) Backrest pad

- (8) Seat cushion cover
- (9) Seat cushion pad
- (10) Hinge CTR
- (11) Hinge LH
- (12) Headrest
- (13) Rear backrest knob
- (14) Striker

- (15) Backrest cover LH
- (16) Backrest frame LH
- (17) Backrest pad LH

Tightening torque: N·m (kgf·m, ft·lb)

T1: 24.5 (2.5, 18.1)

T2: 33 (3.3, 24.6)

B: CAUTION

When removing the front seat from a side airbag loaded vehicle, follow cautions given in the airbag section.

C: PREPARATION TOOL

1. GENERAL TOOL

| TOOL NAME | REMARKS |
|------------------|--|
| Long nose pliers | Used for removing hog ring. |
| Hog ring pliers | Used for installing hog ring. |
| TORX® | Used for removing and installing slide rail. |

2. Front Seat

A: REMOVAL

1) Disconnect the ground cable from battery.

WARNING:

The airbag system is fitted with a backup power source. If the airbag system is serviced within 20 seconds after the ground cable is disconnected, it may inflate.

2) While pressing the headrest lock button, remove the headrest.

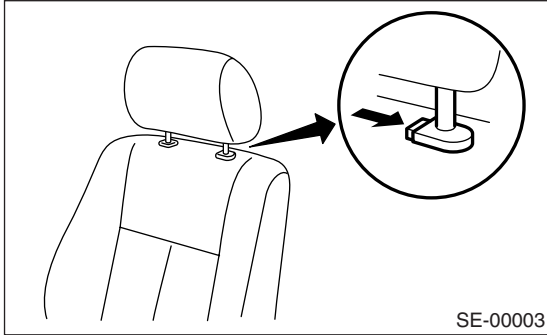

3) Tilt forward the backrest.

4) Move the seat to full front end.

5) Remove the bolt cover at rear end of slide rail.

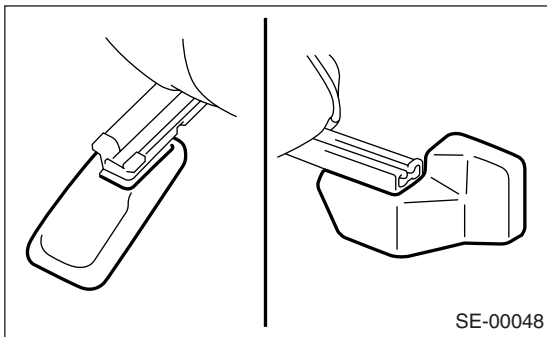

6) Remove the two bolts at rear side of seat rail.

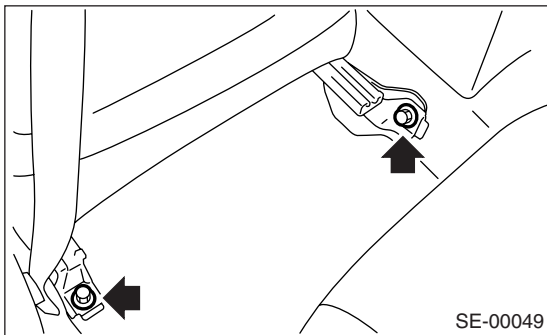

7) Move the seat to full rear end.

8) Remove the two bolts at front side of seat rail.

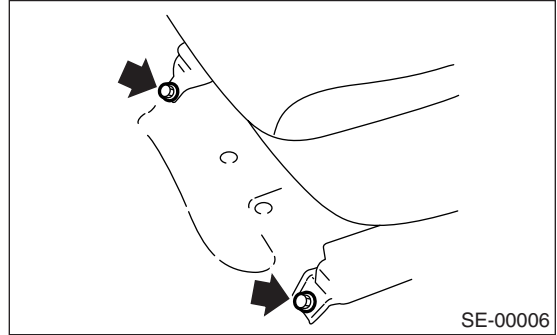

9) Disconnect the side airbag connector under seat.

- Side airbag connector
- Seat belt warning light connector (Driver's seat)
- Seat heater connector (Model with seat heater)

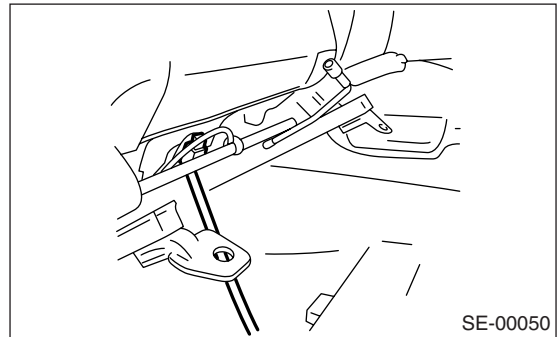

10) Remove the front seat from the vehicle.

B: INSTALLATION

Install in the reverse order of removal.

Tightening torque:

Refer to **COMPONENT** in *General Description*. <Ref. to SE-2, **FRONT SEAT, COMPONENT**, *General Description*.>

C: DISASSEMBLY

1. DRIVER'S SEAT

1) Remove the seat from the vehicle. <Ref. to SE-6, **REMOVAL**, Front Seat.>

2) Remove the reclining lever and reclining hinge cover.

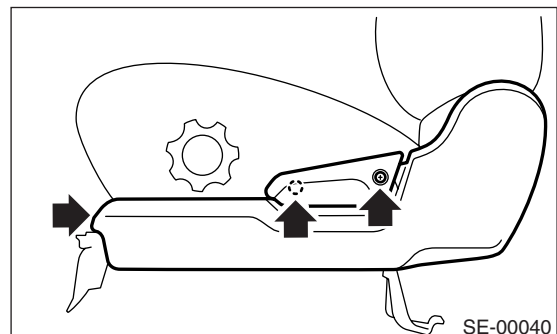

3) Loosen the screw, and then remove the hinge cover.

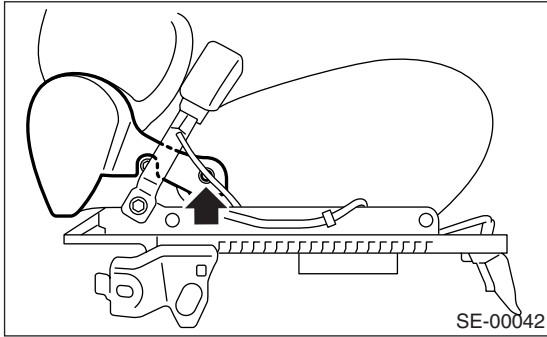

4) Remove two reclining hinge securing bolts on each side.

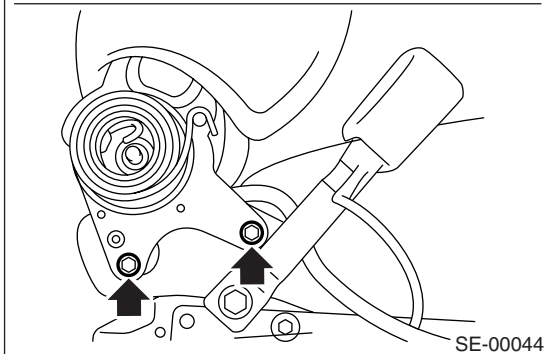
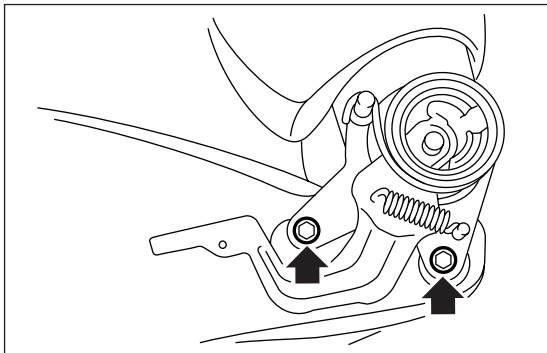

5) Remove the cover (A), and then loosen the nuts to remove arm rest and arm rest guide plate.

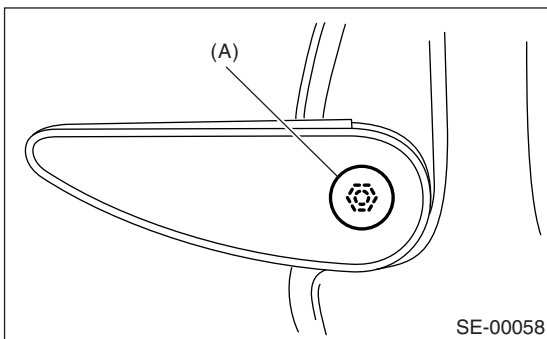

6) Remove the hook at bottom of seat backrest.

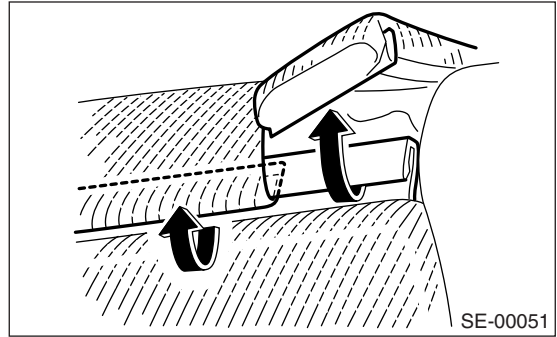

7) Open the zipper behind backrest.

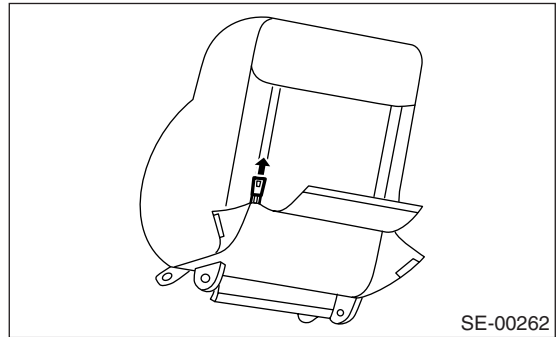

8) Remove the hog rings (A) at side of inside backrest from backrest frame. (Side airbag equipped seat)

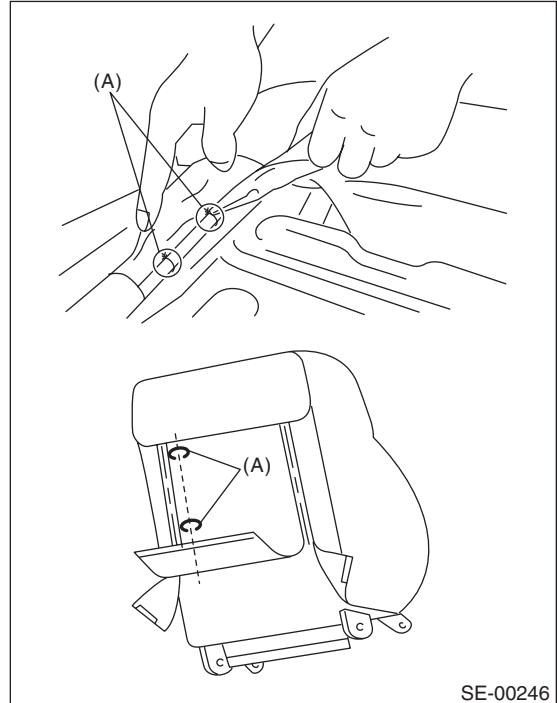

Front Seat

SEAT

9) Remove the hog rings (A) which secure the backrest cover and backrest pad.

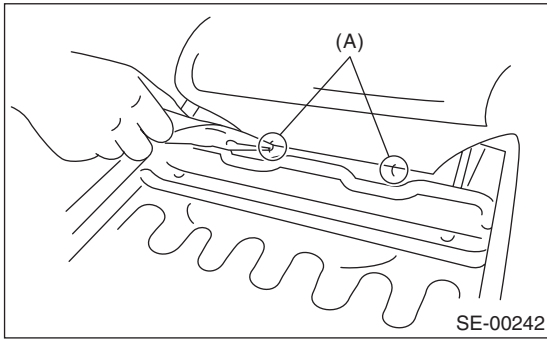

10) Remove the headrest bushes.

NOTE:

Push the headrest bushes to outside of seat from inside, and then remove them.

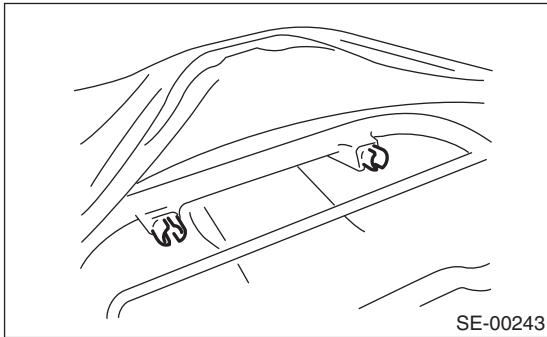

11) Pull out the backrest frame.

12) Remove the hog rings (A) at bottom of seat back.

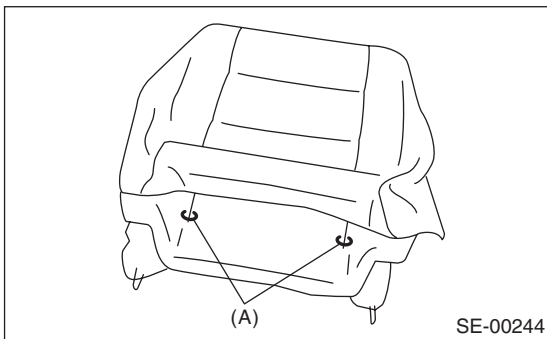

13) Remove the hog rings (A) at front of seat back, and then remove the seat back cover from seat back.

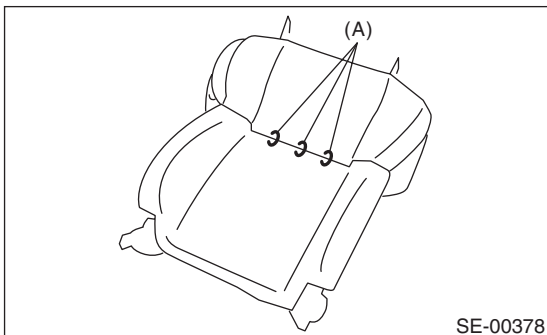

14) Remove the connecting wire (A), and then loosen the bolts and nuts to remove slide rail.

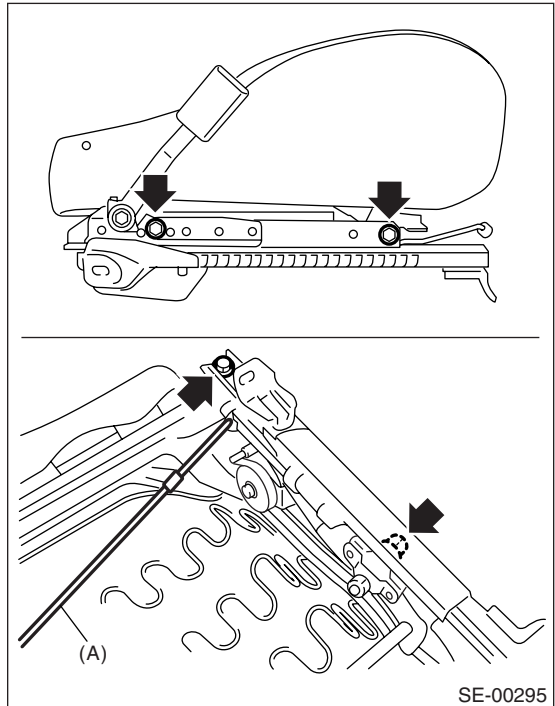

15) Remove the inner belt.

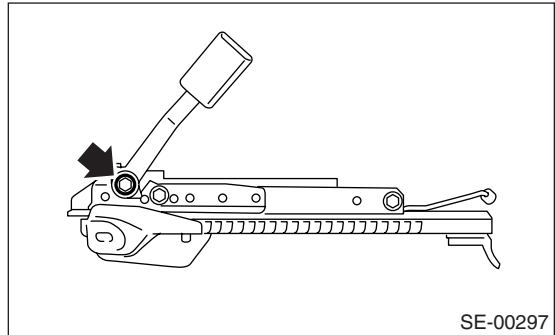

16) Remove the hook (A), and then remove the seat cushion frame.

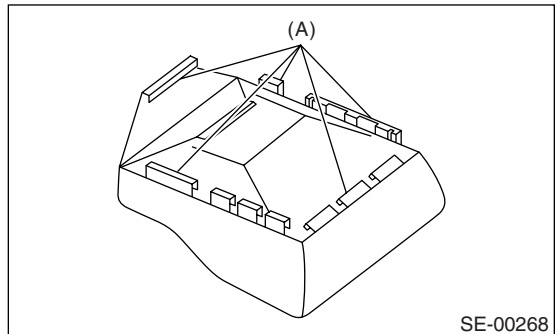

17) Remove the hog rings (A), and then remove the seat cushion cover from seat cushion pad.

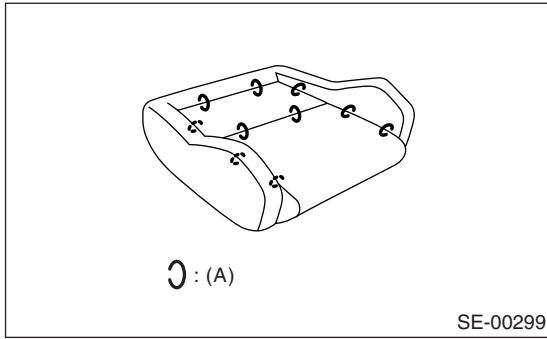

18) Open the zipper at bottom of headrest, and then remove the headrest cover from headrest.

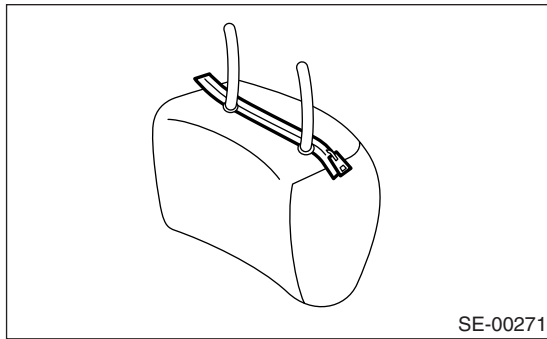

2. PASSENGER'S SEAT

1) Remove the seat from vehicle. <Ref. to SE-6, REMOVAL, Front Seat.>

2) Remove the reclining lever cover and hinge cover.

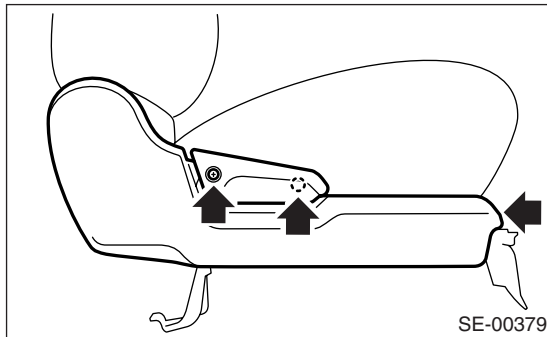

3) Loosen the screw, and then remove the hinge cover.

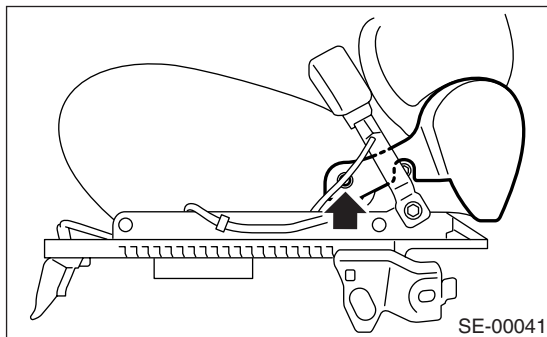

4) Remove two bolts from the reclining hinge on each side.

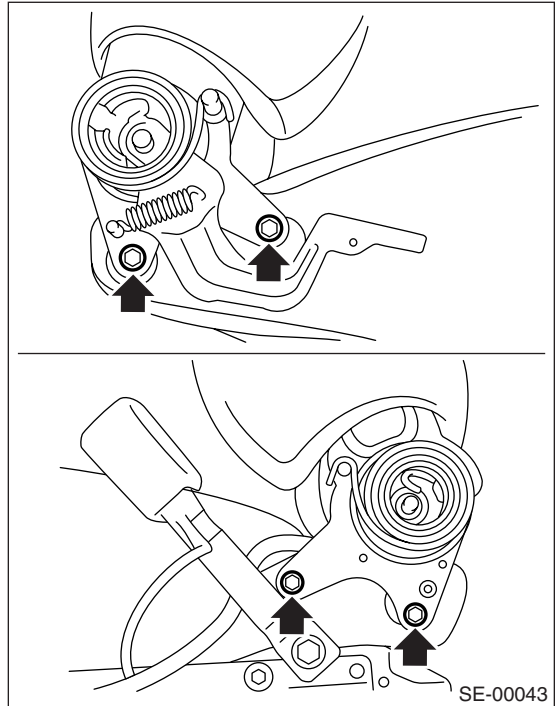

5) Remove the cover (A), and then loosen the nuts to remove arm rest and arm rest guide plate.

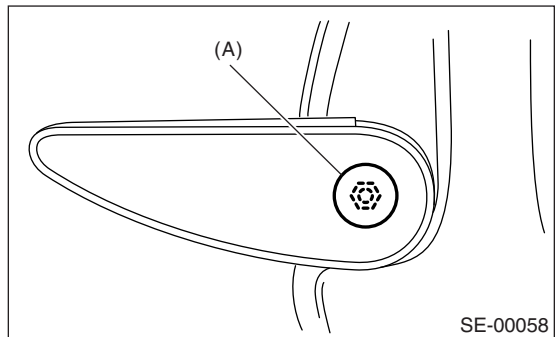

6) Remove the hook at bottom of seat back rest.

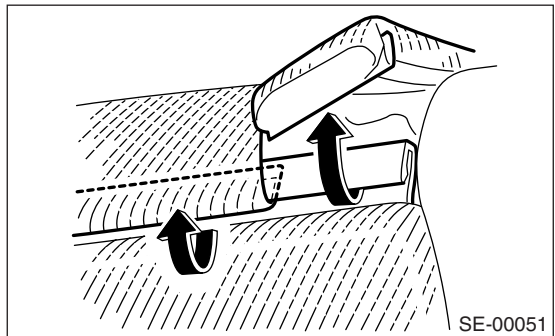

Front Seat

SEAT

7) Open the zipper behind backrest.

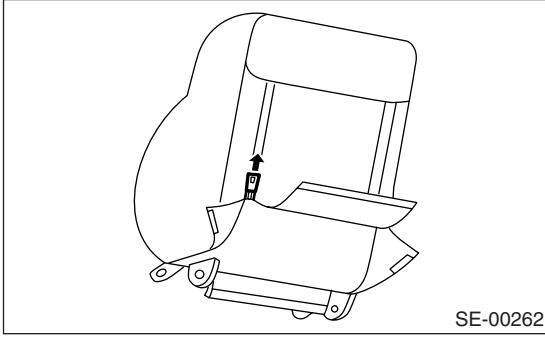

8) Remove the hog rings (A) at side of inside backrest from backrest frame. (Side airbag equipped seat)

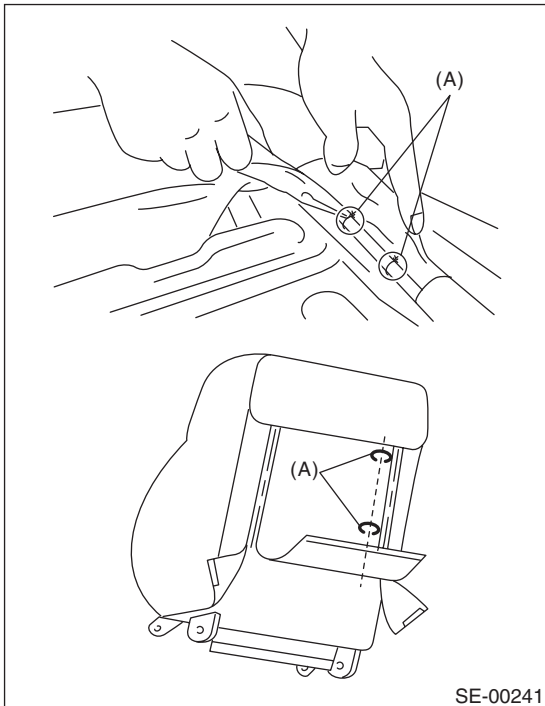

9) Remove the hog rings (A) which secure the backrest cover and backrest pad.

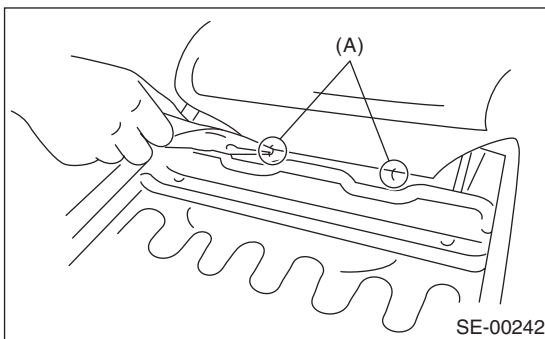

10) Remove the headrest bushes.

NOTE:

Push the headrest bushes to outside of seat from inside, and then remove them.

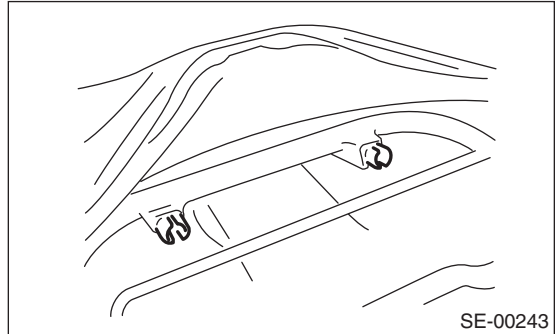

11) Pull out the backrest frame.

12) Remove the hog rings (A) at bottom of seat back. (Side airbag equipped seat)

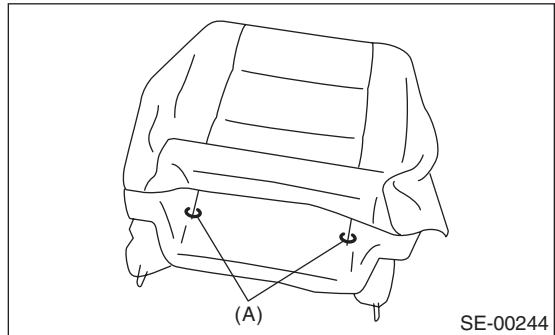

13) Remove the hog rings (A) at front of seat back, and then remove the seat back cover from seat back.

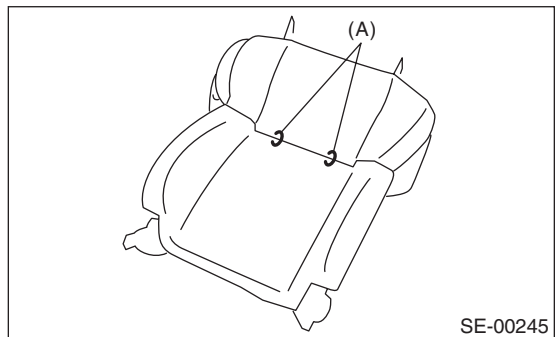

14) Loosen the bolts and nuts to remove the seat cushion from slide rail.

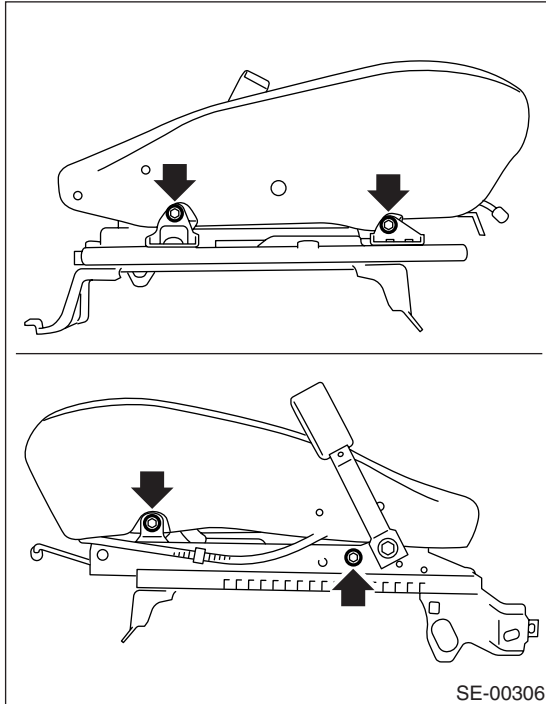

15) Remove the inner belt.

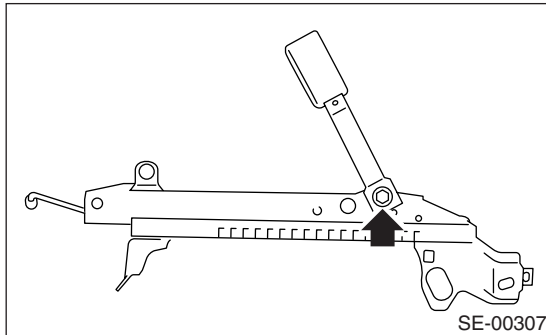

16) Remove the hooks (A), and then remove the seat cushion frame.

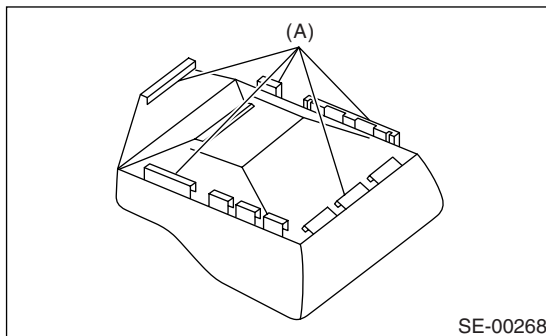

17) Remove the hog rings (A), and then remove the seat cushion cover from seat cushion pad.

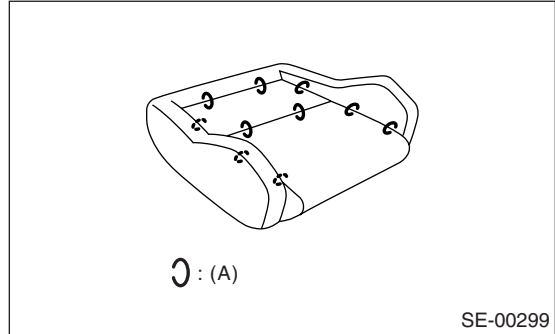

18) Open the zipper at bottom of headrest, and then remove the headrest cover from headrest.

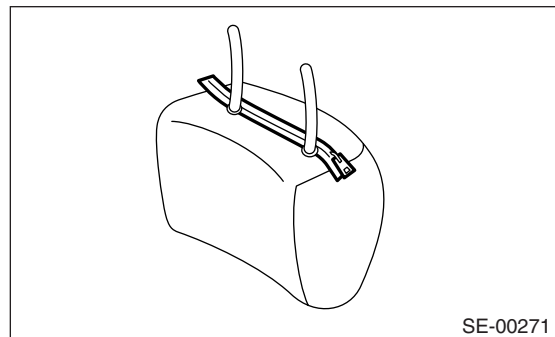

D: ASSEMBLY

1. DRIVER'S SIDE

Assemble in the reverse order of disassembly.

2. PASSENGER'S SIDE

Assemble in the reverse order of disassembly.

CAUTION:

Because it may cause the side airbag to activate incorrectly, observe the following steps to install the side airbag correctly.

- Be careful not to dirty or damage the backrest cover.
- Always use new hog rings.
- Secure the hog ring using hog ring pliers.
- Install the hog ring to its original position, and not to twist or wrinkle the backrest cover.

Tightening torque:

Refer to "COMPONENT" of "General Description". <Ref. to SE-2, FRONT SEAT, COMPONENT, General Description.>

E: INSPECTION

Inspect that there is no tear and fray on backrest cover assembly.

NOTE:

When there is tear or fray on the door side of backrest cover assembly, replace the backrest cover assembly with a new one, because there is a possibility that the side airbag will not operate normally.

3. Rear Seat

A: REMOVAL

1) Remove the bolts, and then detach the rear seat cushion.

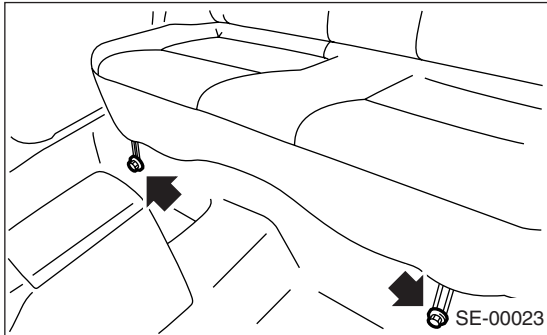

- 2) Remove the headrest.
- 3) Remove the luggage floor mat. <Ref. to EI-50, REMOVAL, Luggage Floor Mat.>
- 4) Fold down the rear seat backrest.
- 5) Turn over the mat to remove bolts.

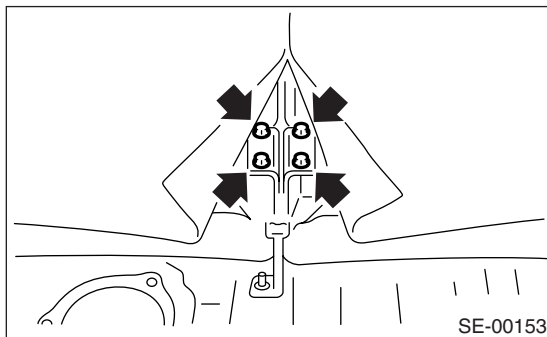

6) Remove the rear seat backrest.



B: INSTALLATION

Install in the reverse order of removal.

Tightening torque:

Refer to **COMPONENT** in **General Description**. <Ref. to SE-4, REAR SEAT, COMPONENT, General Description.>

C: DISASSEMBLY

- 1) Remove the rear seat. <Ref. to SE-13, REMOVAL, Rear Seat.>
- 2) Remove the hog rings (A) from around the seat backrest.

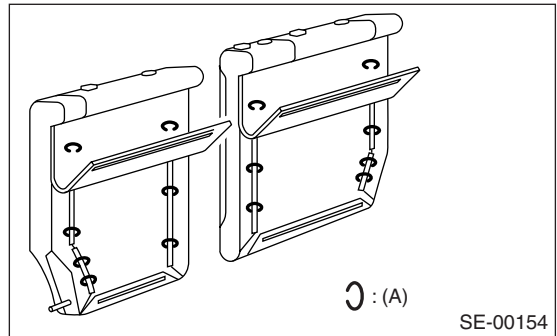

3) Remove the hog rings (A) on front side of cushion pad, and then remove the cover.

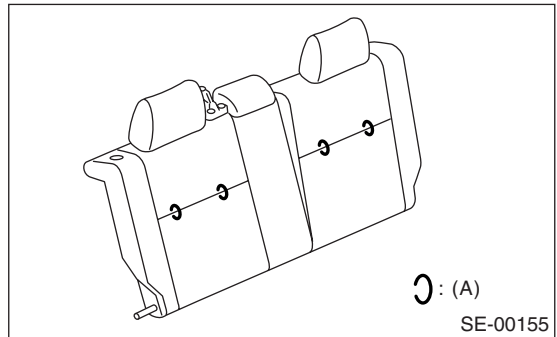

4) Remove the hog rings (A) from around the seat cushion.

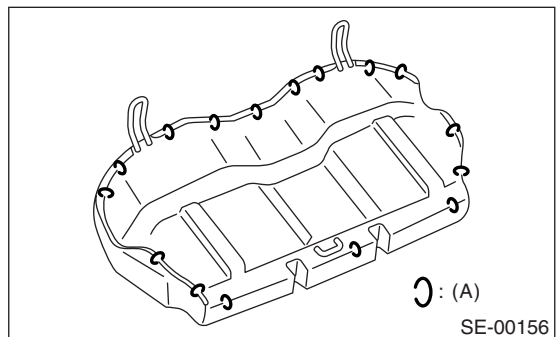

5) Remove the hog rings (A), and then remove the cover.

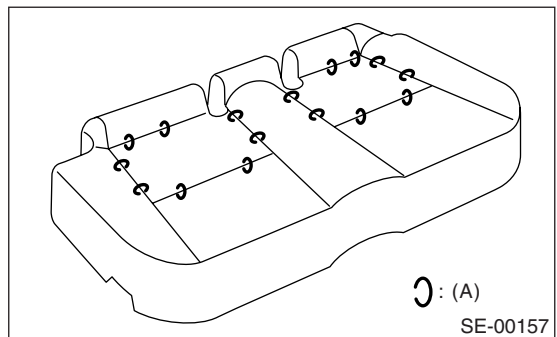

D: ASSEMBLY

Assemble in the reverse order of disassembly.

NOTE:

- Do not contaminate or damage the cover.
- While installing the hog rings, prevent the seat from getting wrinkled.